



# New Construction Application

Permit #: \_\_\_\_\_ Fee: \_\_\_\_\_  Paid

The City of Urbana | Department of Zoning and Compliance  
205 South Main Street, Urbana, Ohio 43078 | ZoningandCompliance@ci.urbana.oh.us | (937) 652-4322 | www.urbanaohio.com

## Applicant Information

Name:

Mailing Address:

Phone Number:

Email:

Project Address:

Project Contact (Contractor, Project Manager, Etc):

Project Contact Phone Number:

Project Contact Email:

Property Parcel ID:

Property Subdivision:

Property Lot Number

Property Zoning District:

FEMA Floodplain Designation:

Estimated Cost of Construction:

**\*Owner Information**

**\*Information of the person responsible for the project. If we needed to contact someone about the project, who would that be?**

**\*Please provide a copy of the property's legal deed, description, and plat map section. This information can be obtained at the Champaign County Recorders Office.**

**\*This information can also be found on the Property Card at the Champaign County Auditors website: <http://champaignoh.ddti.net/>.**

**\*The Zoning Officer will fill in this information during their review.**

**\*Used for tracking purposes only.**

## Work Type

Choose One:

Choose All That Apply:

- Residential
- Commercial

- New Building
- Building Addition

# Proposal

## District Regulations:

	R1		R2		R3		BR-1		B-2		M-1		Residential	Non-Residential
	Principal	Accessory	Principal	Accessory	Principal	Accessory	Principal	Accessory	Principal	Accessory	Principal	Accessory	Fence	
Front Setback	35'		25'		25'		25'		40'		50'		0**	
Side Setback	15'	5'	6'	5'	10'	5'	5'		0'		10'	5'	0**	
Rear Setback	30'	10'	30'	10'	30'	10'	20'	10'	30'		40'		0**	
Max Height	35'	20'	35'	20'	40'	20'	40'	20'	40'	20'	Variable*		6'	8'
Lot Occupancy	25%		30%		30%		50%		40%		50%		N/A	
Min. Floor Area	1,200	N/A	850	N/A	800	N/A	800	N/A	N/A		N/A		N/A	

\*Maximum height is the distance between the nearest point of the structure and the closes adjacent right-of-way line.

\*\*Fences cannot be placed closer than 3' from any right-of-way line and cannot be placed within platted utility easements without utility release letters obtained from all utility companies that have rights to said easement.

## Site Plan:

If below area does not provide adequate space, or if you have separate plans, please attach.

### Show:

- Lot Shape & Dimensions
- North Arrow
- Adjacent Street Names
- Existing Structures
- Proposed Structures with:
  - Dimensions
  - Setbacks

### Example:

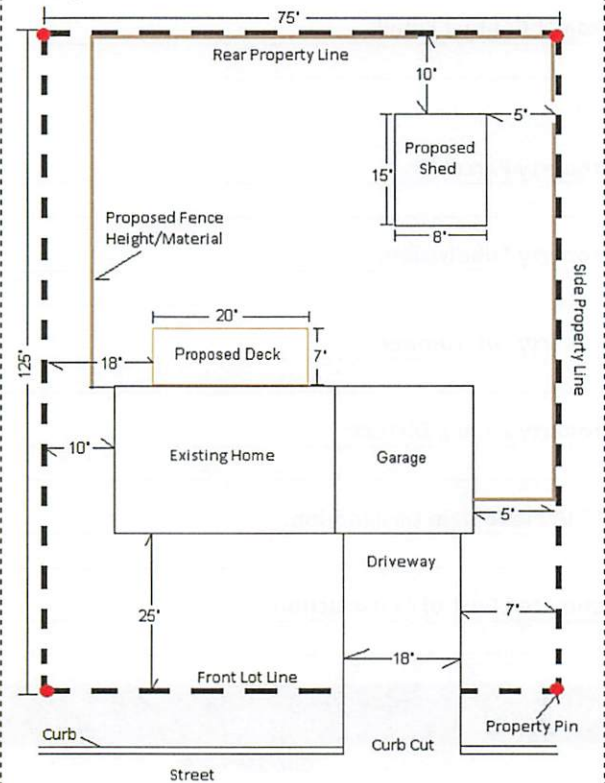

Structure Width (ft): _____	Front Setback (ft): _____
Structure Depth (ft): _____	Side Setback (ft): _____
Structure Area (sq. ft.): _____	Rear Setback (ft): _____
Structure Height (ft): _____	Lot Occupancy (%): _____

This is my application for a New Construction Permit. I have the authority to file this application, have read this application in its entirety, and certify the information contained herein and all attachments are correct to the best of my knowledge. I understand that I am solely responsible for the information contained herein that all structures shall be built exactly as stated in this application and be compliant with the Planning and Zoning Code. I understand this application may be denied or that any permit issued based on this application may be revoked.

Applicant Signature: \_\_\_\_\_ Date: \_\_\_\_\_